



HOPITAL DUPUYTREN 1

1^{er} étage

Ailes B / Blocs 5 et 6



Opération tiroir

Unité de Nutrition / Consultation Anesthésie / Oncologie / Soins Palliatifs

Dossier de plans n°4

Cloisons – Revêtements – Faux-Plafonds

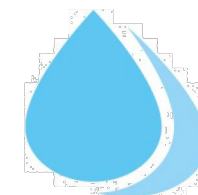

**Direction des constructions,
de la sécurité
et du patrimoine**

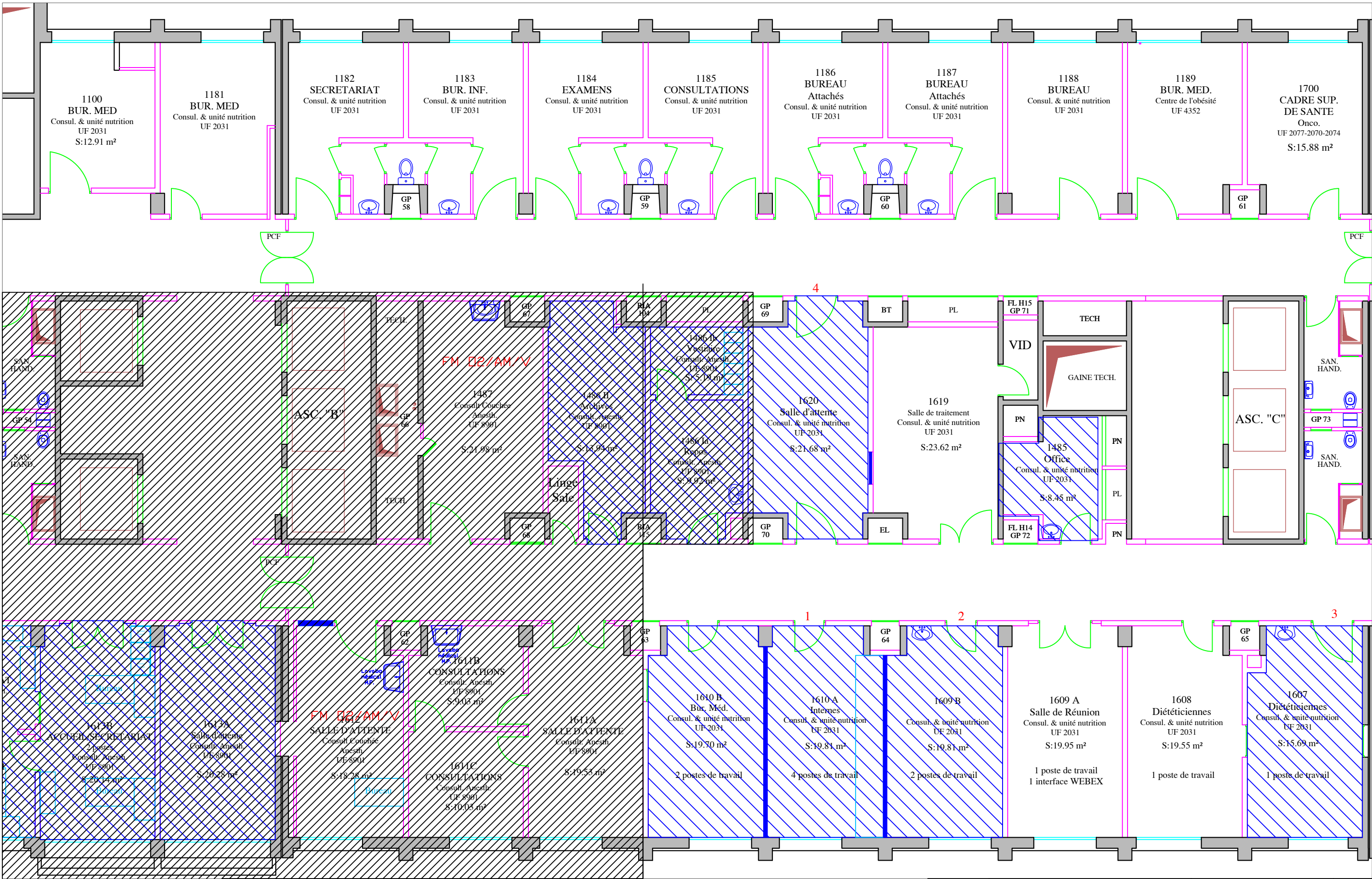

**Cloison neuve
(environ 32 m²)**

**Sol PVC U3P3
(environ 110 m²)**

**1 - 2 Bloc porte 83x210
3 - 4 Bloc porte 118x210**



Date: 19-05-25

Format A3

D1 - 1er étage
Unité de nutrition

4.1

Echelle 1/100

Cloisons
Revêtement de sol

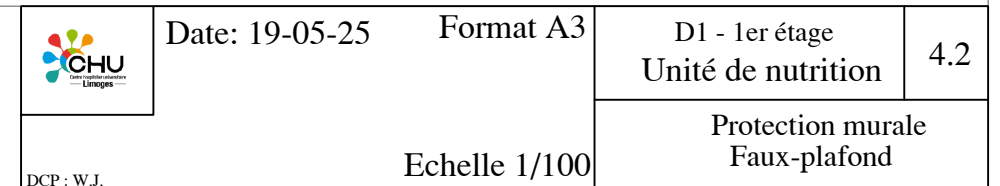

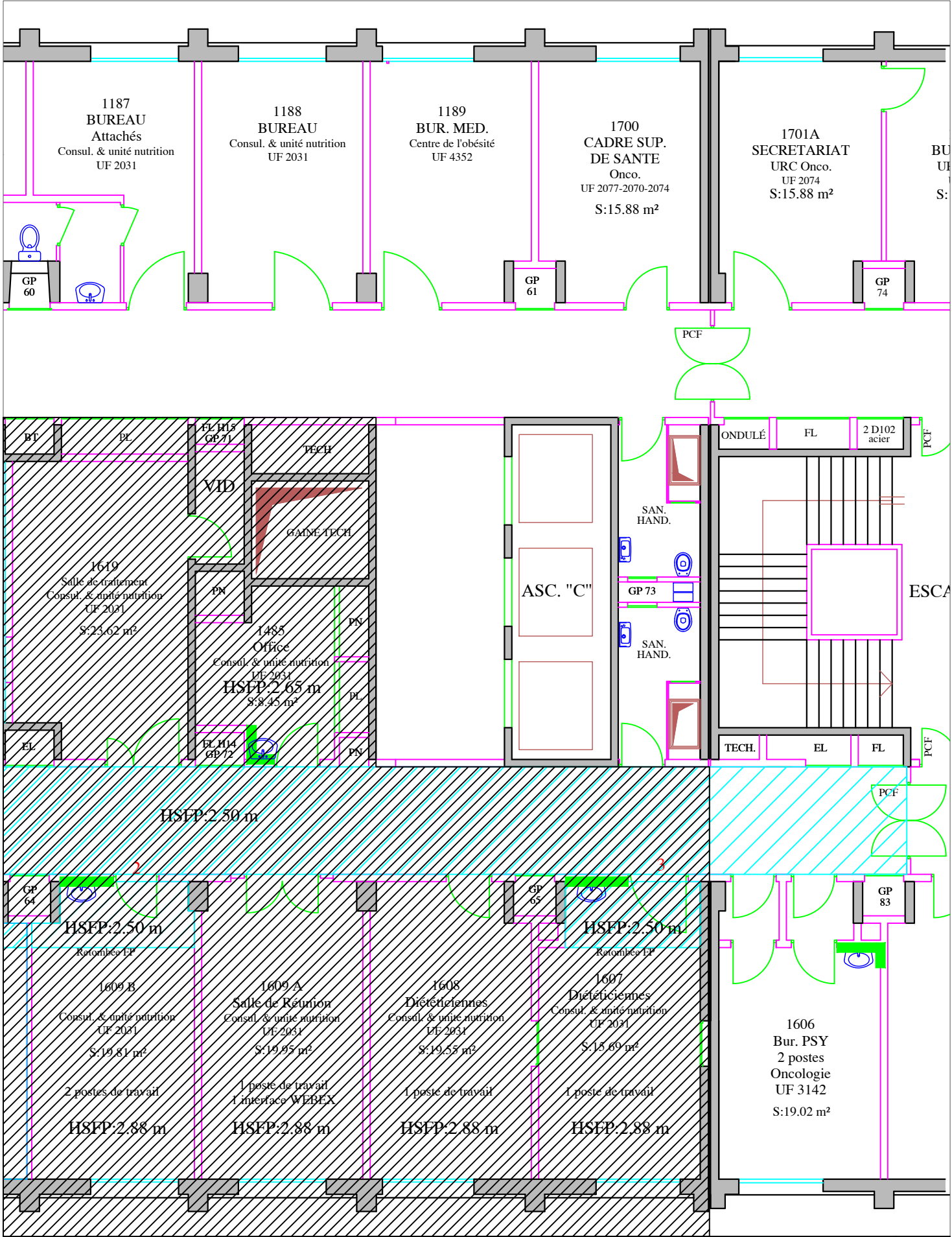
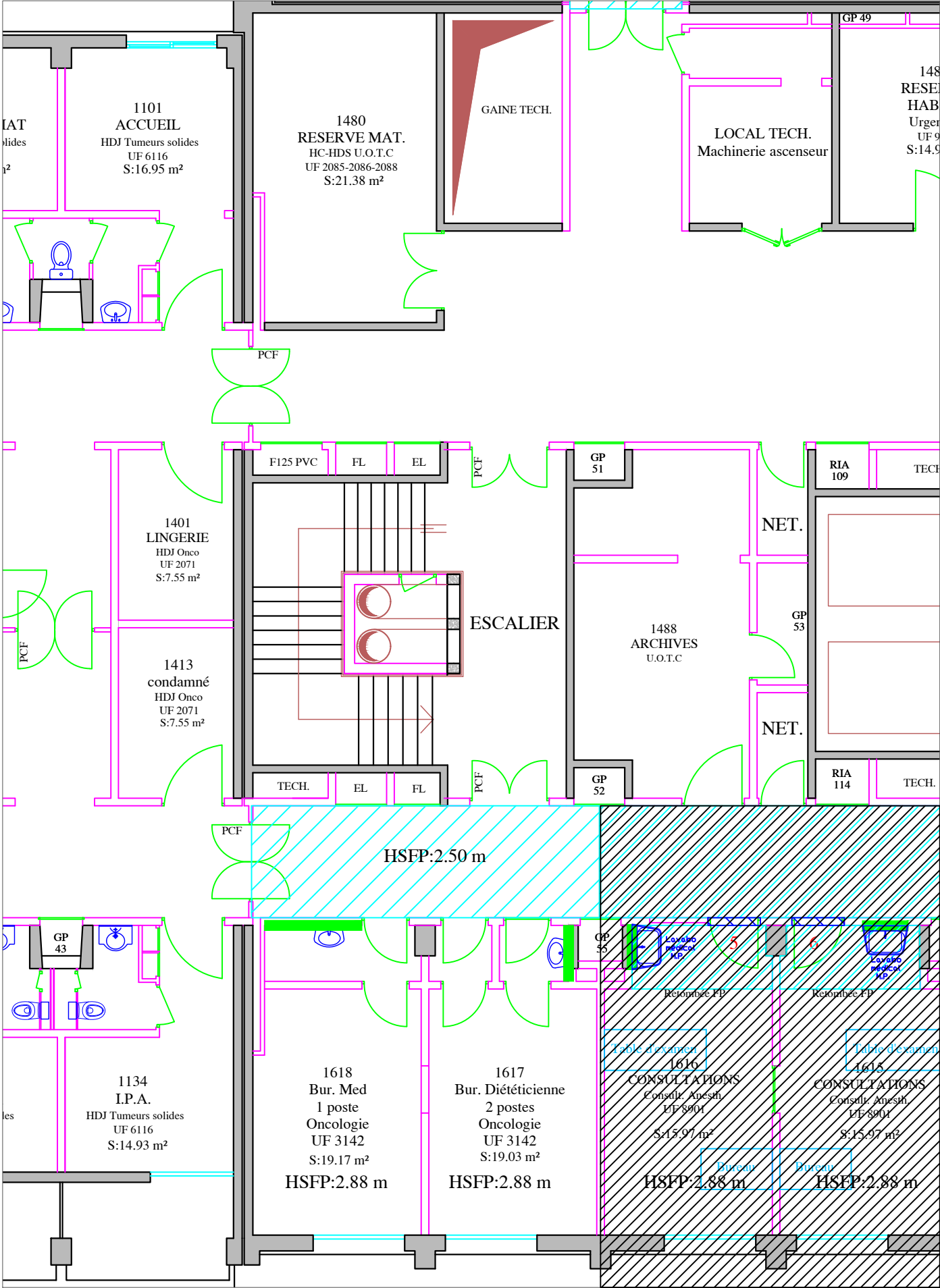

SPM Ht 600 mm
(environ 3ml)

FP 600x600
(environ 15 m²)



Date: 19-05-25

Format A3

D1 - 1er étage
Consult. Anesthésie



4.3

DCP : W.J.

Echelle 1/100

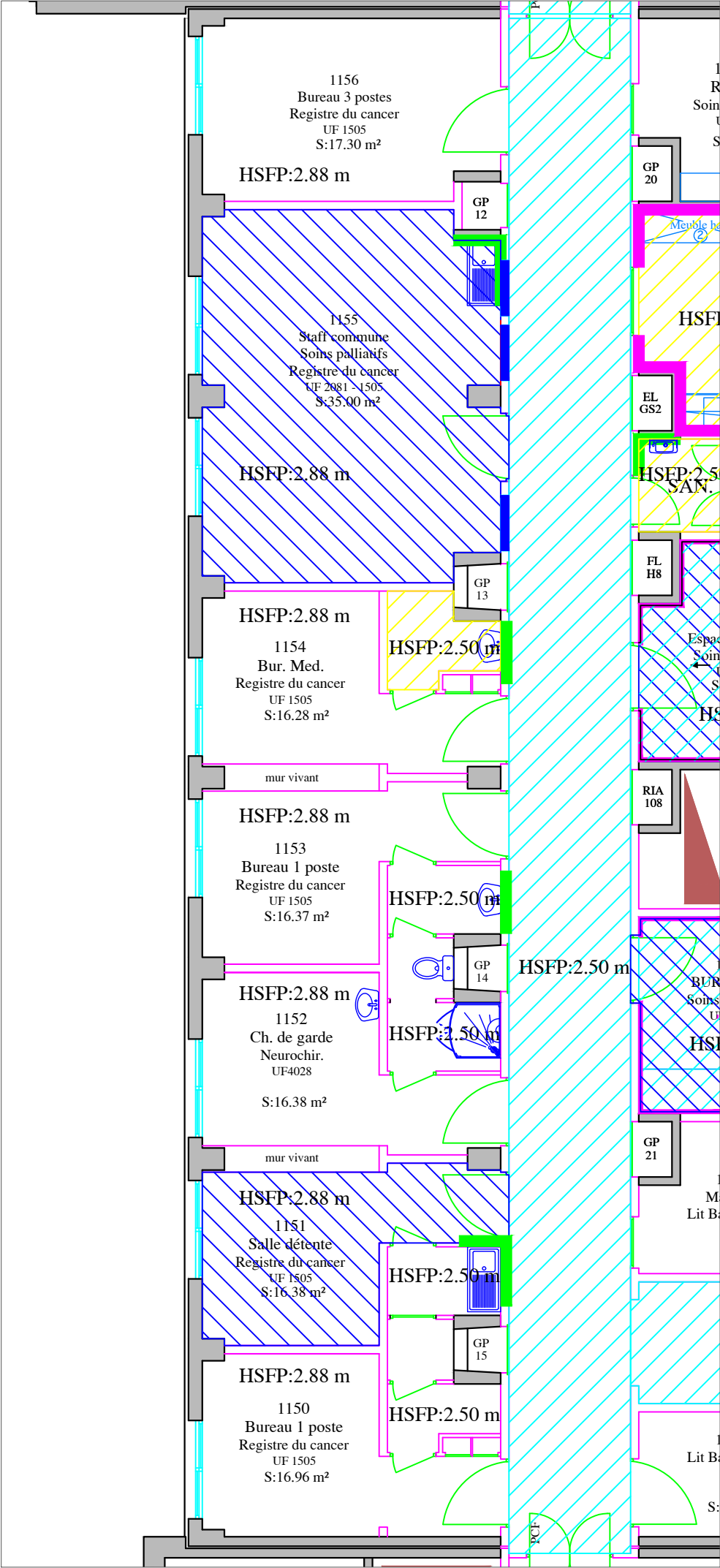
Protection murale
Faux-plafond

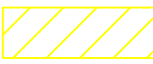
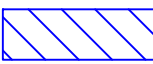

-  **FP 600 x 600 acoustique**
(environ 71 m², compris le sas d'entrée de l'aile)
-  **FP 600 x 600 Hygiène**
(environ 3 m²)
-  **Sol PVC U3P3**
(environ 48m²)
-  **SPM Ht 600 mm**
(environ 4ml)
-  **Cloison neuve**
(environ 3 m²)

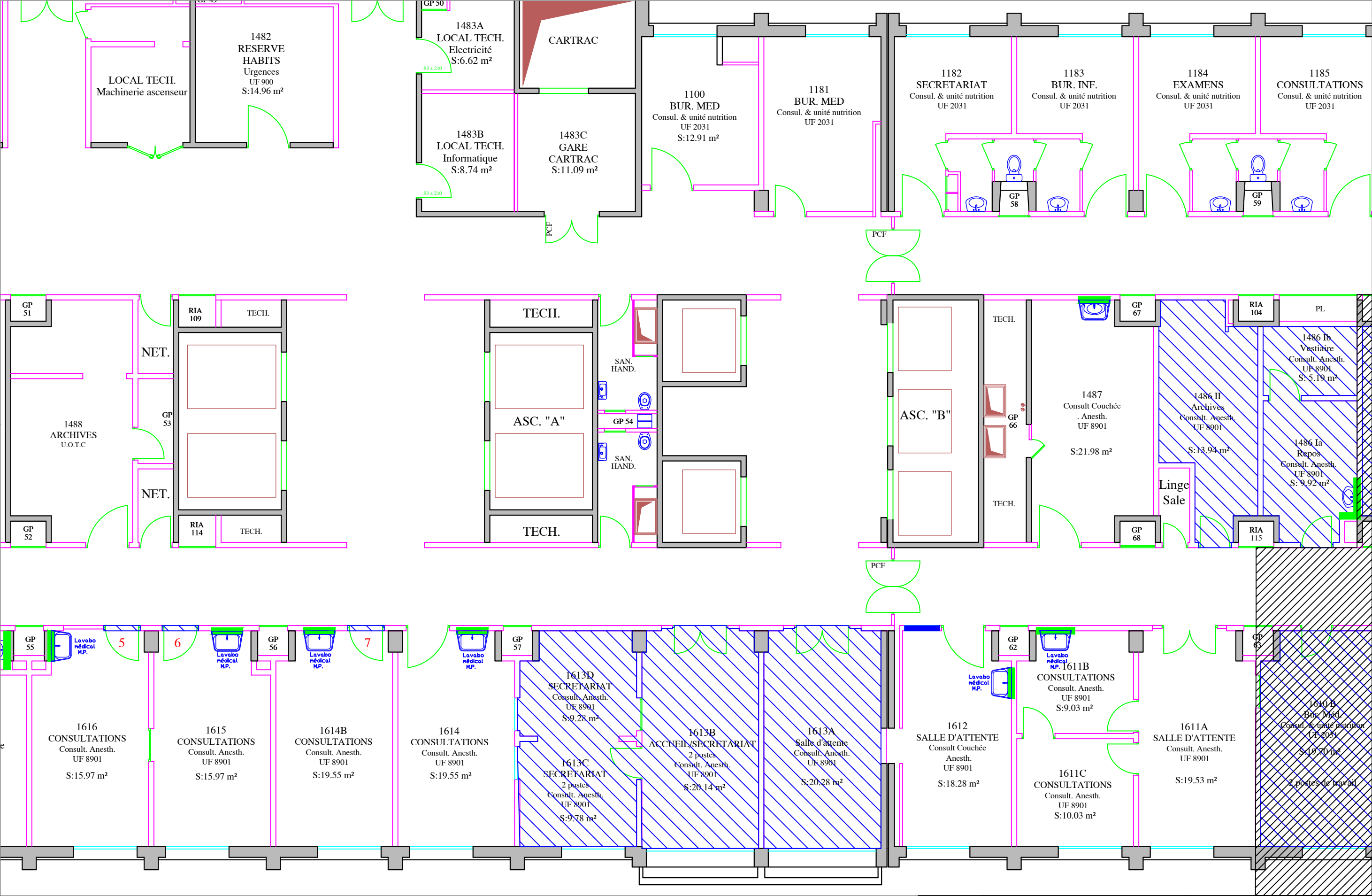

Cloison neuve
(environ 1 m²)

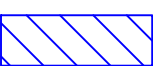

Sol PVC U3P3
(environ 93 m²)

5 - 6 - 7 Bloc porte 93x210



Date: 19-05-25

Format A3

D1 - 1er étage
Consult. Anesthésie

4.5



DCP : W.J.

Echelle 1/100

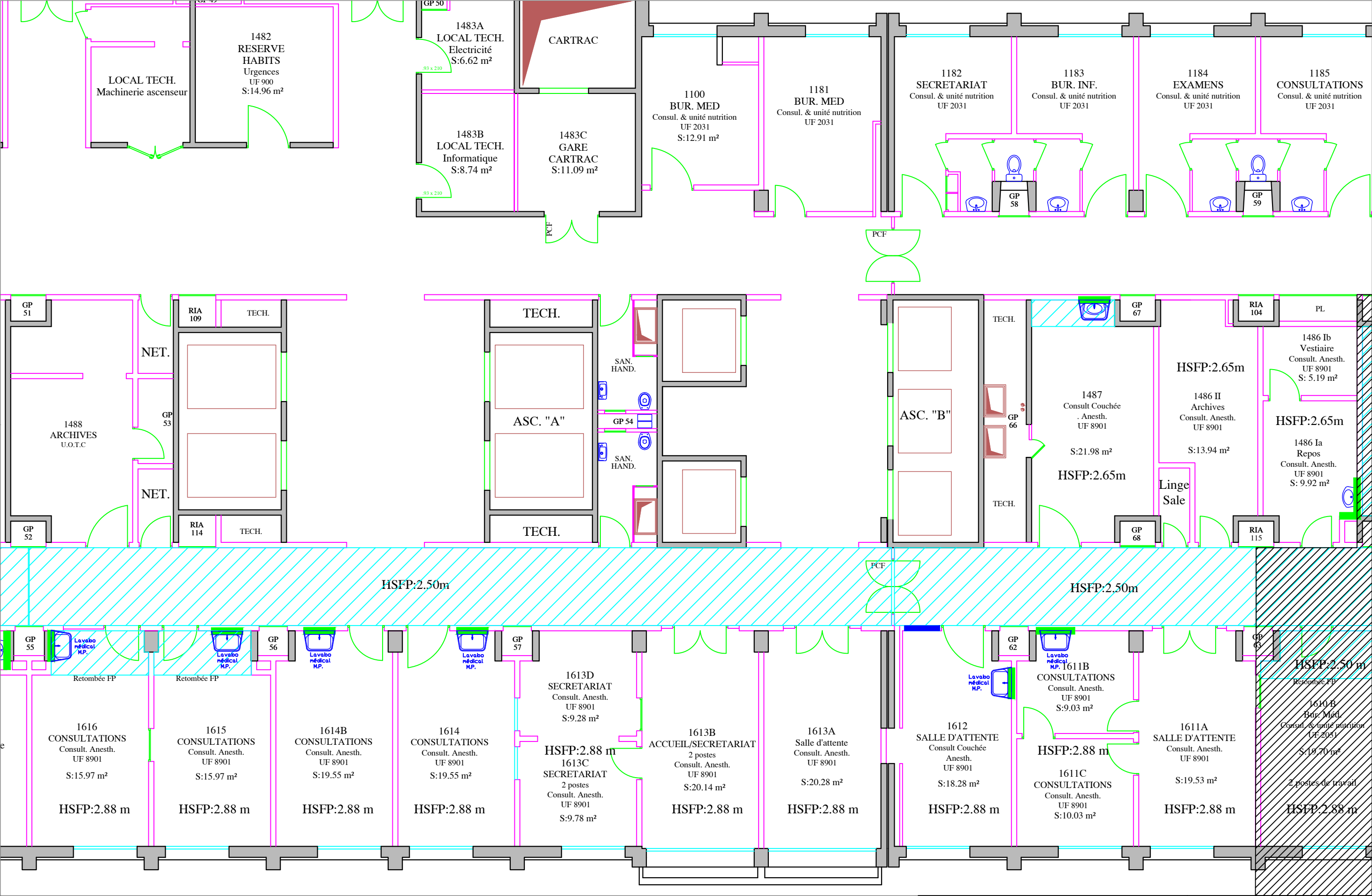
Cloisons
Revêtement de sol

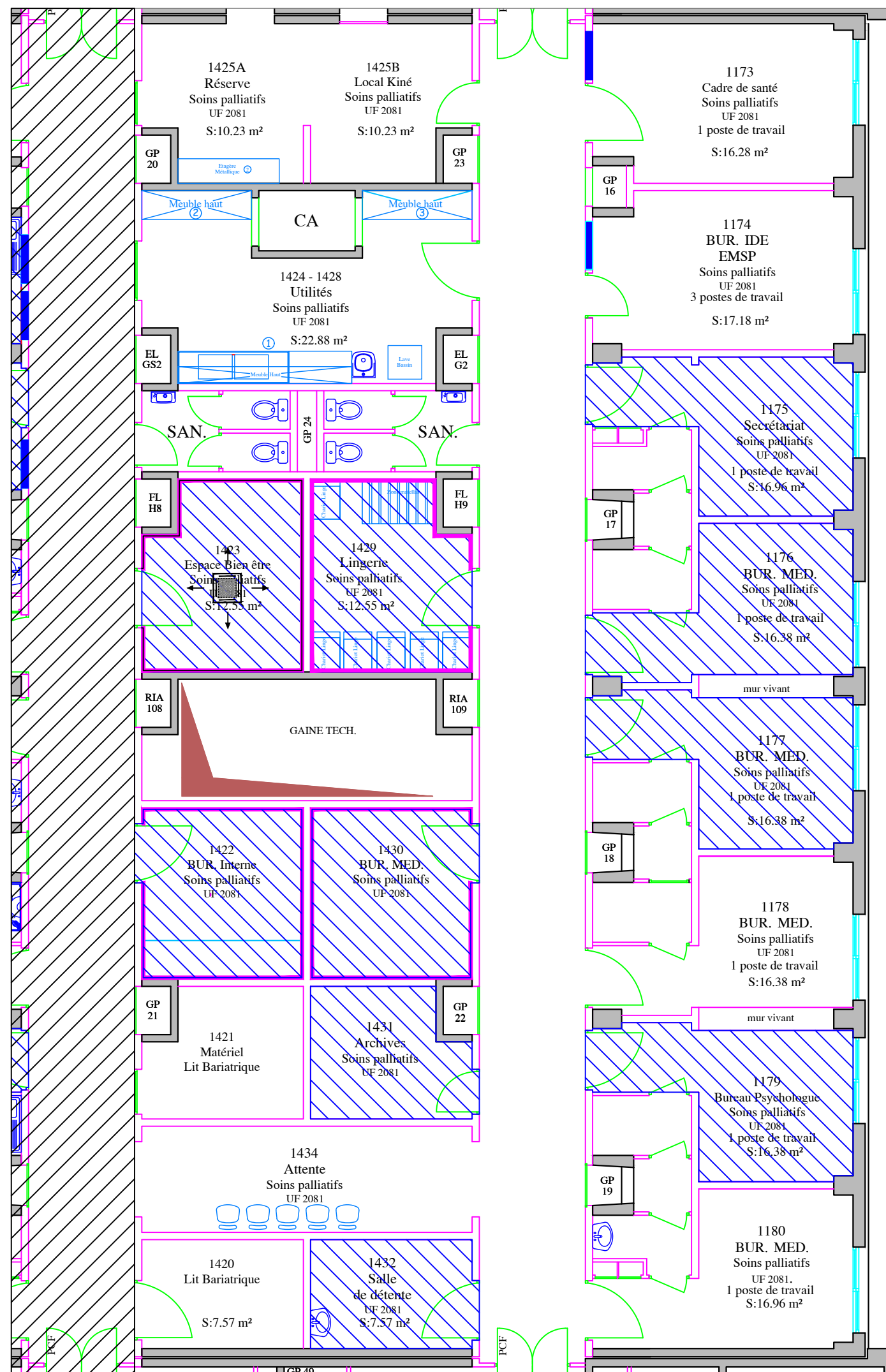

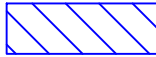





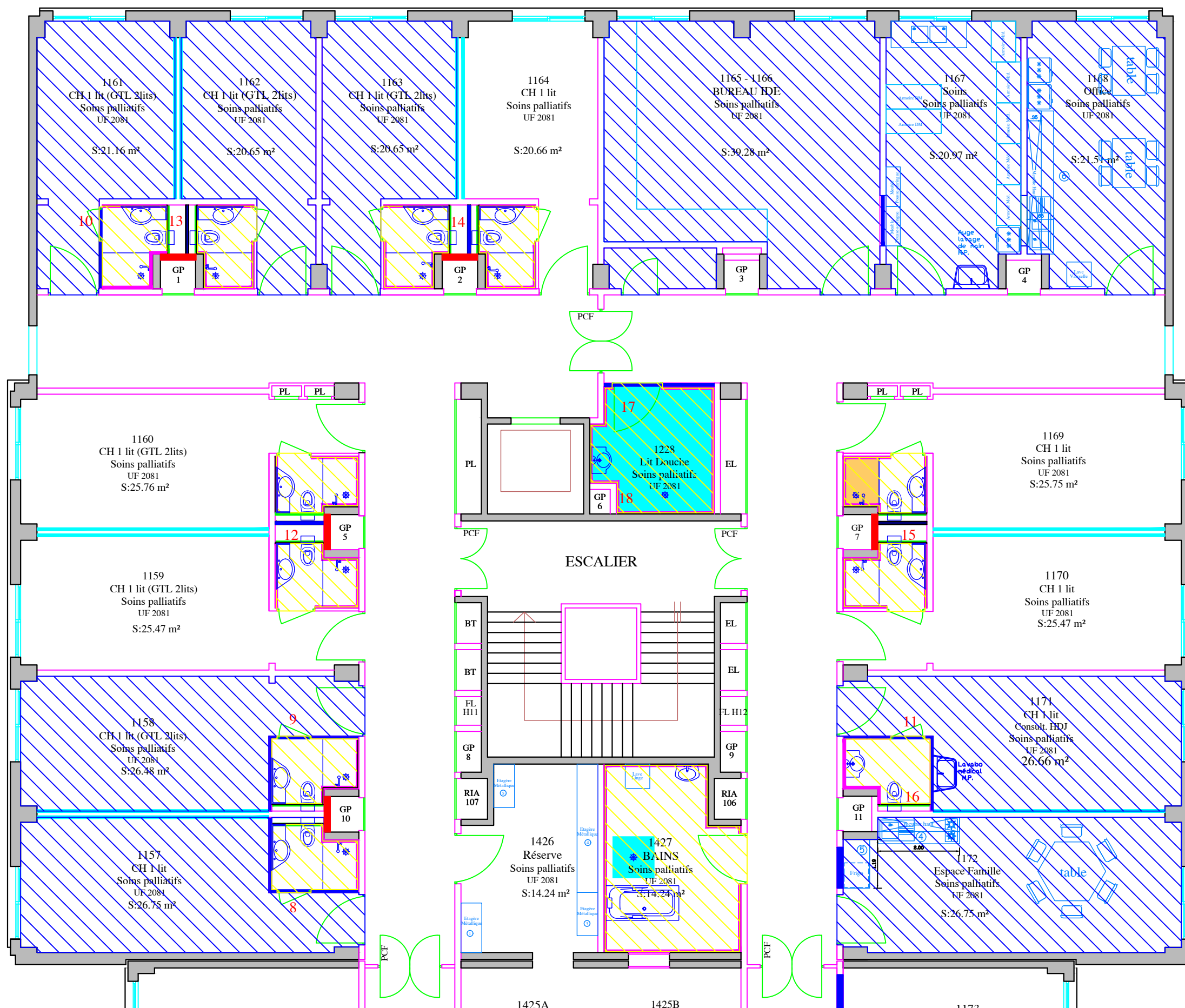

-  **Doublage BA13 hydro**
(environ 135 m²)
-  **Sol PVC U3P3**
(environ 109 m²)
-  **Cloison neuve**
(environ 2 m²)

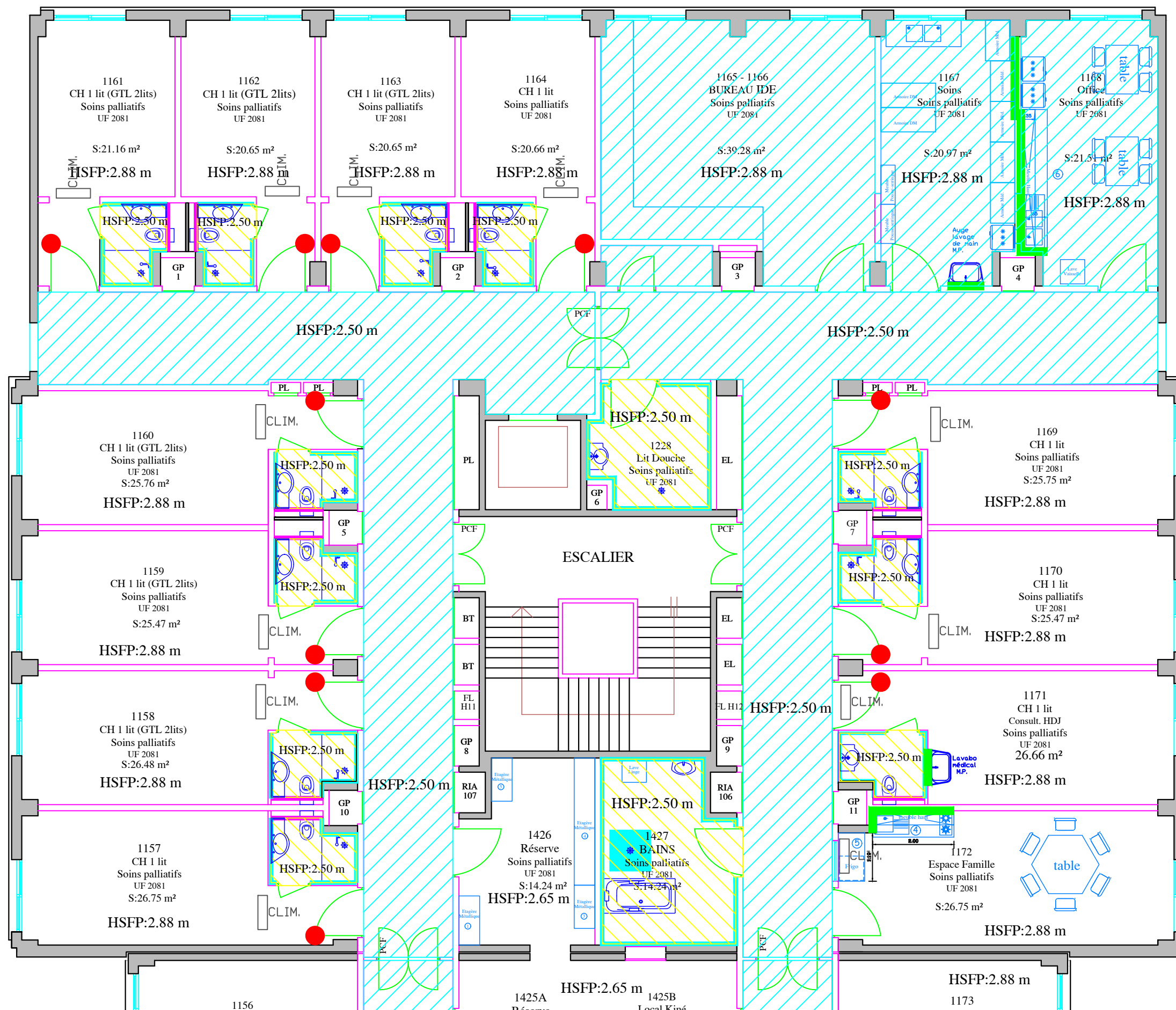

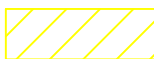

- 8-9-10-11 Bloc porte 83x210**
- 12-13-14-15-16 Trappe 600x600**
- 17 Bloc porte 118x210**
- 18 Trappe 600x210**
- Sol PVC U3P3 Sécurit (environ 54m²)**
- Sol PVC U3P3 (environ 236m²)**
- Revêtement mural PVC Ultra ht 1.50 m (environ 85m²)**
- Cloison neuve (environ 73 m²)**
- Cloison technique (environ 43 m²)**
- Doublage BA13 hydro Ht 2.7m (environ 195 m²)**
- Rebouchage EI60 (environ 5 m²)**
- Chape avec forme de pente (environ 10m²)**
- Chape avec forme de pente 12 cm Ht (environ 11 m²)**



-  **FP 600 x 600 acoustique**
(environ 209 m²)
-  **FP 600 x 600 Hygiène**
(environ 54 m²)
-  **SPM Ht 600 mm**
(environ 12 ml)
-  **SPM Ht 1500 mm**
(environ 14 ml)
-  **SPM 200 x 2000 mm**
derrière la poignée de porte
coté circulation (11 unité)
-  **PVC Mural Douche Ht 2500 mm**
(environ 210 m²)